

# JHE-L-GET HIGH-PROFILE LIGHTED END SEAL

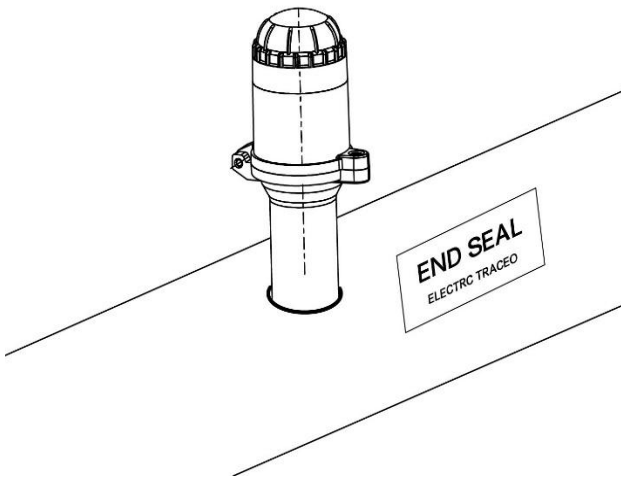

## DESCRIPTION:

The JHE-L-GET is a end seal kit with a light that indicates voltage at the end of the circuit. It is designed for use with HTR industrial parallel heating cable.

Once installed, the end seal is easily re-entered for maintenance and the heating cable can be accessed without removing the end seal. The LED indicator light provides excellent visibility.

This kit may be installed at temperatures as low as  $-40^{\circ}\text{F}$  ( $-40^{\circ}\text{C}$ ). For easier installation, store above freezing until just before installation.

Kit is rated for 85 to 265 V.

Make sure voltage rating of light is the same as that of the heat-tracing circuit.

## APPROVAL:

Class I, Div.2, Groups A, B, C, D;

Class II, Div.2, Groups E, F, G;

Class III; Type 4X, IP65;



## TOOLS REQUIRED:

- Wire cutters
- Utility knife
- Needle nose pliers
- Slotted screwdriver or nutdriver

## ANNDITIONAL MATERIALS REQUIRED:

- Pipe strap
- JSR03 fiber glass tape

## KIT CONTANTS:

Item	Qty.	Description
A	1	End seal stand and light assembly
B	2	Insulated parallel crimps
C	1	End seal label
D	1	Core sealer

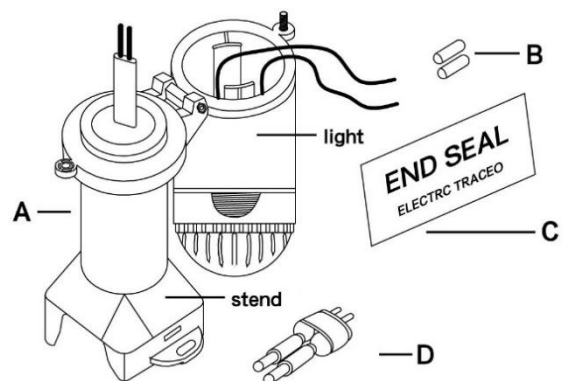

# Heating cable types

**1**

- Allow approximately 24 in (60 cm) of heating cable for installation.
- Cut off heating cable end at about 45° for easier insertion.
- Apply lubricant for easier insertion into stand.

24 in (60 cm)  
12 in (30 cm)  
45°  
Indentation (bus wire connection)

**2**

- Optional: If stand is to be installed on bottom side of pipe, knock out drain hole prior to inserting cable.
- Slide heating cable through stand.
- Square off cable with 90° cut.

12 in (30 cm)  
Drain hole

**3**

2 1/4 in (57 mm)

- Measure exactly 2 1/4 in (57 mm).
- Lightly score outer jacket around and down as shown.
- Bend heating cable to break jacket at score; peel off jacket.
- Remove all exposed braid.

**4**

Do not cut bus wires

~ Measure exactly 1 3/8 in (35 mm)

~ Lightly score inner jacket around and down as shown

1 3/8 in 35 mm

~ Peel off jacket

~ Notch core

1/4 in 5 mm

~ Peel bus wire from core.

~ Score core between bus wires at inner jacket.

~ Bend and snap core.

~ Peel core from bus wire.  
~ Remove any remaining core material from bus wires.

5

- Mark the jacket as shown.

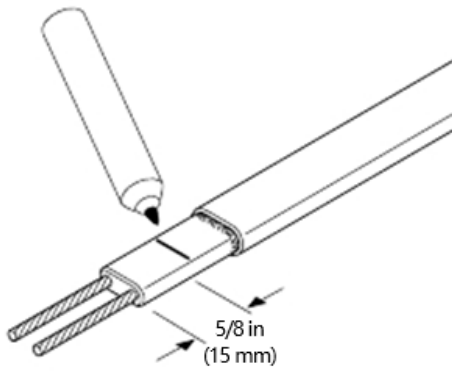

8

- Trim exposed conductors

1/2 in (13mm)

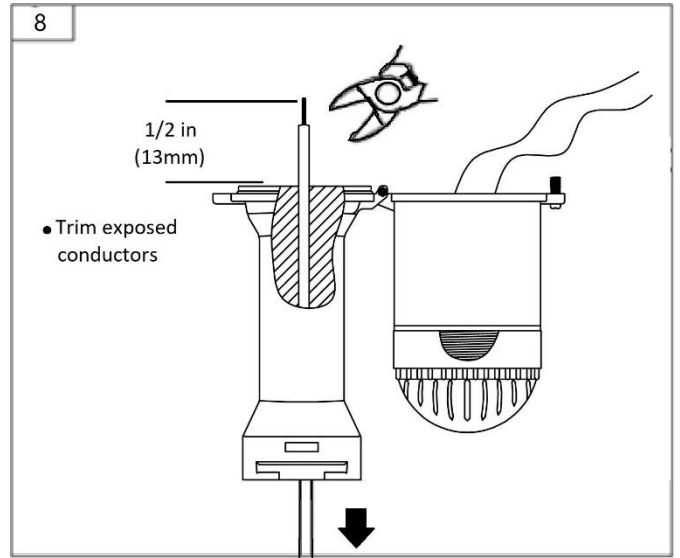

6

- Push core sealer onto the heating cable to the mark made in step 5.

**Note:** Extra force may be required for larger cables or at lower temperatures.

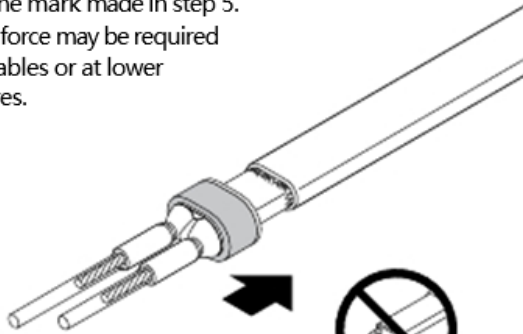

Make sure the bus wires do not kink, bunch, or crossover.

9

- Fasten end seal stand to pipe with strap. Do not pinch heating cable. Be sure pipe strap is under heating cable.
- Loop and tape extra heating cable to pipe. Minimum bend radius is 3/4in(20mm).

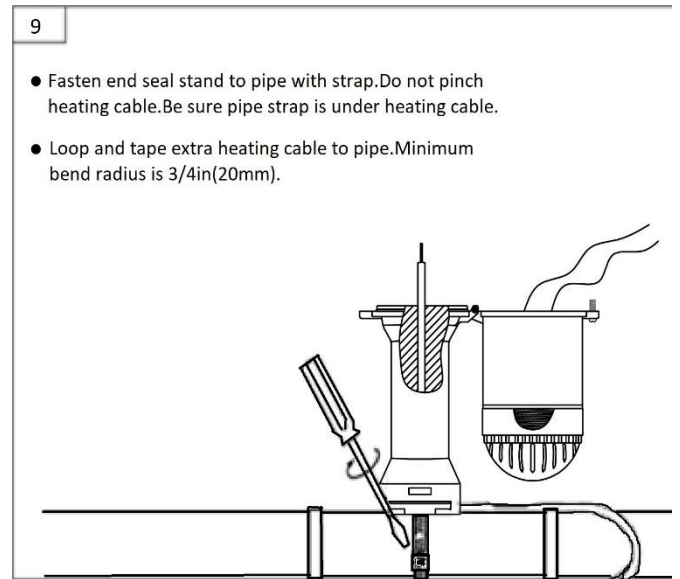

7

- Pull cable back through end seal stand until braid is just visible above strain relief.

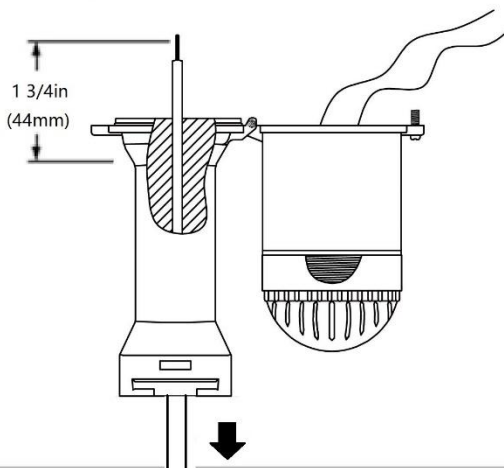

10

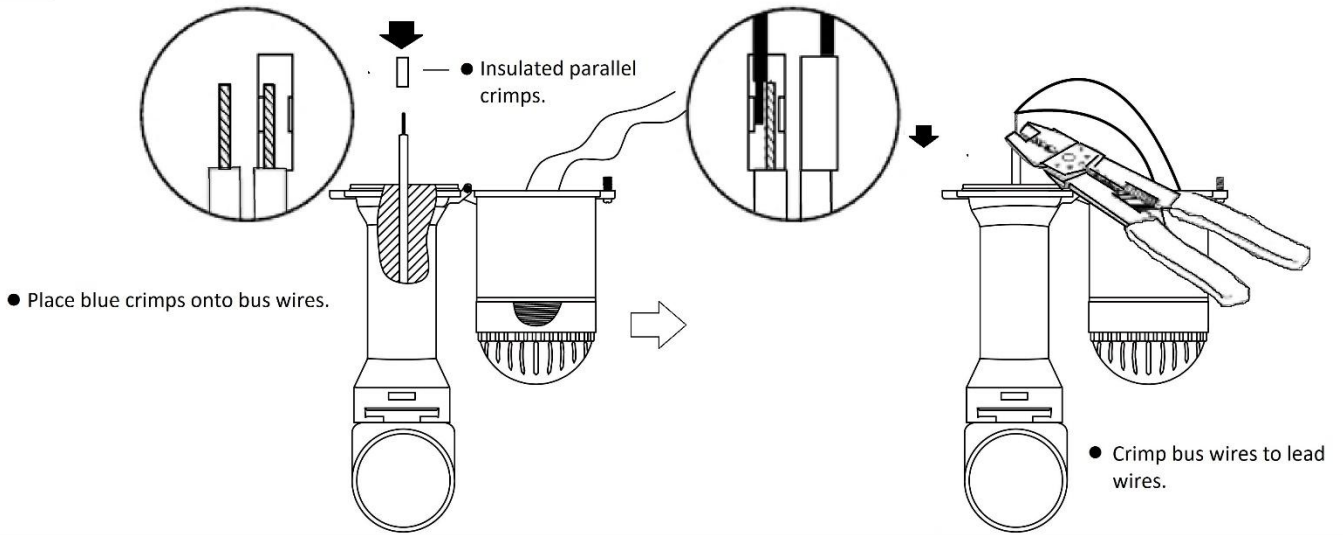

11

- Push excess wire inside light.

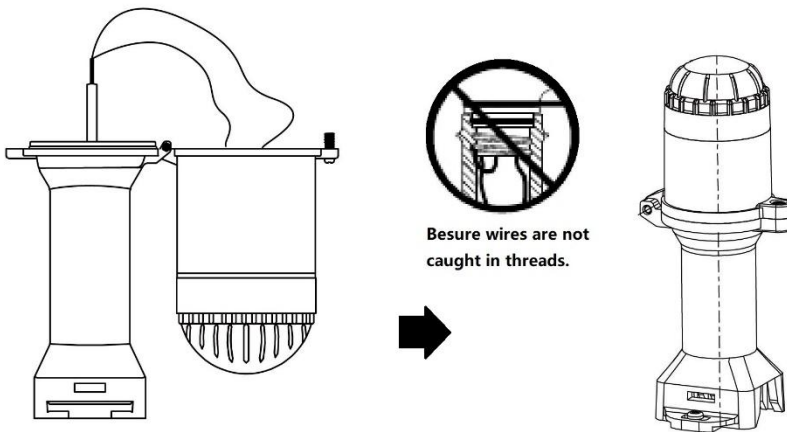

12

- Insert cable tie through the slot on stand and the slot on the light, then tighten.

